



Installation Instructions Part Number 300-637

2011-14 Chrysler 300
2011-14 Dodge Charger
2011-14 Dodge Challenger
2011-14 Dodge Durango
2011-14 Jeep Grand Cherokee
2012-14 Jeep Wrangler
3.6L Pentastar V6



Parts List

AIR-KIT637PA	Aluminum Plate	(1)
AIR-KIT637G	Gasket	(1)
AIR-KIT637H	Hardware	
	6mmx51mm Screw	(4)
	6mm Flat Washer	(4)



INTAKE SYSTEMS FOR VEHICLES LISTED ARE 50 STATE LEGAL. SEE AIRAID.COM FOR CARB STATUS ON EACH PART FOR A SPECIFIC VEHICLE.

Thank you for purchasing the PowerAid Throttle Body Spacer. Please read the instruction manual carefully before proceeding with the installation. Your PowerAid Throttle Body Spacer was carefully inspected and packaged. Check that no parts are missing, or were damaged during shipping. If you need any assistance please call 1-800-858-3333 to speak with a representative in our Customer Service Center before returning the product.
Thank you for selecting AIRAID.

These instructions depict an installation being performed on a Dodge Challenger and are meant to be a guide for all other makes and models listed. While specific details may vary from vehicle to vehicle, the general install procedure remains the same.



1. Disconnect the negative battery cable!

Lift up on the engine cover to unseat it from its mounting grommets, remove it from the vehicle, and set aside.



2. Disconnect the air temperature sensor from the air intake tube, just forward of the throttle body.

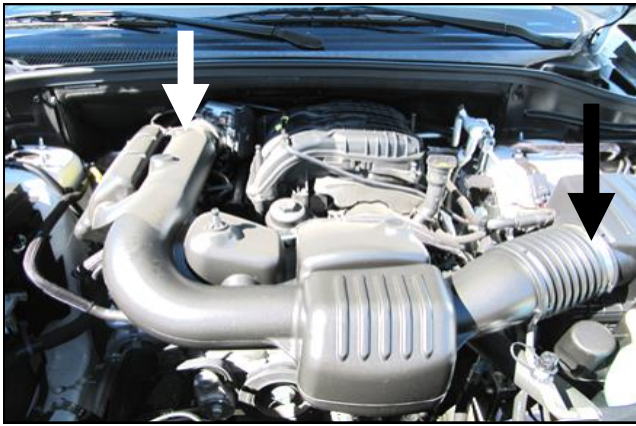

3. Loosen the clamps on both ends of the intake tube, and remove from the engine compartment.

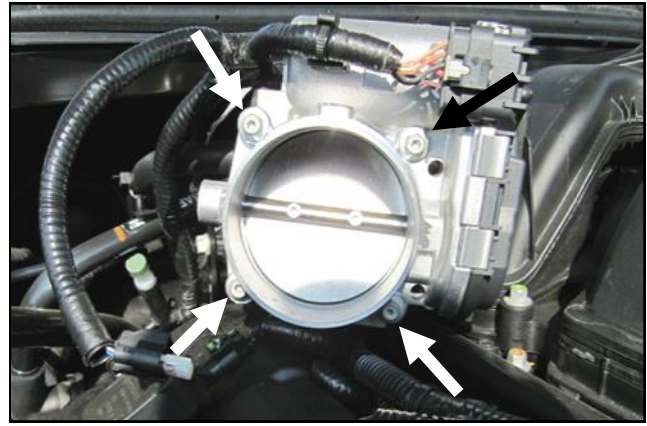

4. Remove the four bolts that secure the throttlebody to the intake manifold. Without disconnecting the wiring harness, remove the throttlebody from the intake manifold and set it to the side.



5. Insert the PowerAid spacer into the intake manifold. The gasket will go between the PowerAid and the throttlebody.
 *Note: Poweraid spacer must be installed with bore protruding into intake manifold away from throttle body. Incorrect installation will hinder performance. Reference picture below for spacer orientation.

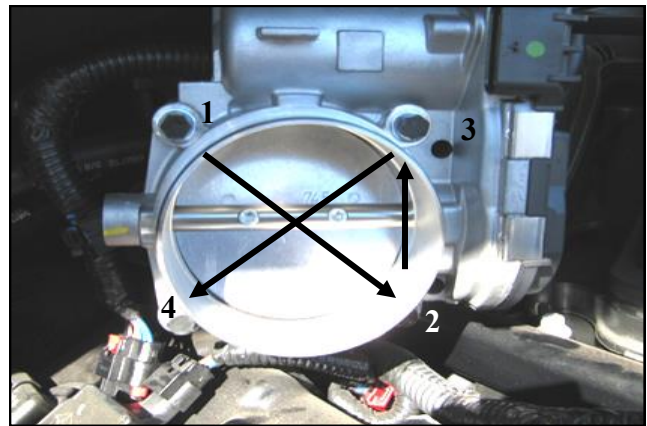

6. Reinstall the throttlebody on top of the Poweraid Spacer using the four bolts and washers that are supplied with the kit. Tighten the bolts evenly to the vehicle manufacturers specifications, in a "X" pattern.



7. Reinstall the intake tube and engine cover in the reverse order that they were removed. Make sure to reconnect the temperature sensor.

Re-connect the negative battery cable!



Example of proper spacer installation. Spacer must protrude into intake manifold and away from throttle body.

AIR-I30637C
 Rev. 02.08.18

The sound of power...The "whistle" means its working!

Contact your nearest Airaid dealer for an Airaid Intake System for your car, truck or SUV.

Airaid. 1455 Citrus St., P.O. Box 1329, Riverside, CA. 92502 1-800-498-6951 AiraidInfo@airaid.com